

LF850, 856ST, LF856

2 1/2" - 10" Double Check/Double Check Detector Assemblies

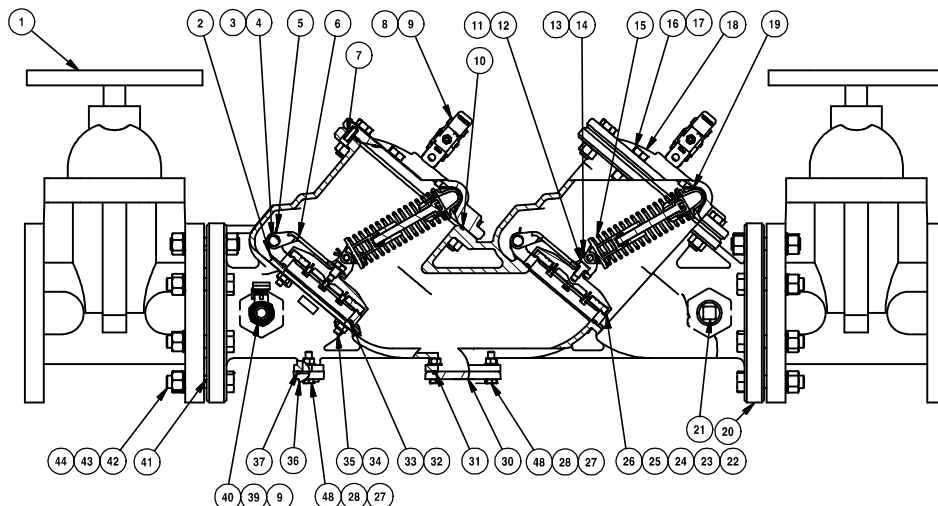

| Ordering Code | Style | Size | List Price |
|---------------|-------|------|------------|
|---------------|-------|------|------------|

Disc Assembly

| | | | |
|--------|-----|-------------|-----------|
| 905466 | ALL | 2 1/2" & 3" | \$ 234.50 |
| 905467 | ALL | 4" | 246.00 |
| 905468 | ALL | 6" | 323.00 |
| 905469 | ALL | 8" & 10" | 599.50 |

Kit Includes: Items 11, 12, 22, 23, 24, 25, 26

Total Rubber Kit

| | | | |
|--------|-----|-------------|--------|
| 905490 | ALL | 2 1/2" & 3" | 134.00 |
| 905491 | ALL | 4" | 146.00 |
| 905492 | ALL | 6" | 168.00 |
| 905493 | ALL | 8" & 10" | 279.00 |

Kit Includes: Items 10, 25, 31, 32, 33, 37

Spring Module

| | | | |
|--------|--------------------------------------|-------------|--------|
| 905470 | LF850 (1st & 2nd) 856ST, LF856 (1st) | 2 1/2" & 3" | 101.00 |
| 905471 | LF850 (1st & 2nd) 856ST, LF856 (1st) | 4" | 130.00 |
| 905472 | LF850 (1st & 2nd) 856ST, LF856 (1st) | 6" | 211.00 |
| 905473 | LF850 (1st & 2nd) 856ST, LF856 (1st) | 8" & 10"*** | 234.50 |
| 905474 | 856ST (2nd) | 2 1/2" & 3" | 147.50 |
| 905475 | 856ST (2nd) | 4" | 170.00 |
| 905476 | 856ST (2nd) | 6" | 254.00 |
| 905477 | 856ST (2nd) | 8" & 10"*** | 247.50 |
| 905608 | LF856 (2nd) | 2 1/2" & 3" | 144.00 |
| 905609 | LF856 (2nd) | 4" | 166.00 |
| 905610 | LF856 (2nd) | 6" | 248.50 |
| 905611 | LF856 (2nd) | 8" & 10"*** | 242.00 |

Kit Includes: Items 15

Seat Ring / Arm Assembly

| | | | |
|--------|-----|-------------|--------|
| 905486 | ALL | 2 1/2" & 3" | 422.00 |
| 905487 | ALL | 4" | 438.00 |
| 905488 | ALL | 6" | 625.00 |
| 905489 | ALL | 8" & 10"*** | 622.00 |

Kit Includes: Items 2, 3, 4, 5, 6, 32, 33, 34, 35

**10" uses 8" internals

*The wetted surface of this product contacted by consumable water contains less than 0.25% of lead by weight.

Supersedes all other price lists / Prices subject to change / Weights are estimated

¹Grooved ends available on all OS&Y gate valves in some models and sizes. Expect larger lead times.

Detailed maintenance manuals can be downloaded at www.FEBCOonline.com.

| Ordering Code | Style | Size | List Price |
|---------------|-------|------|------------|
|---------------|-------|------|------------|

Check Replacement Kit

| | | | |
|--------|--------------------------------------|-------------|-----------|
| 905478 | LF850 (1st & 2nd) 856ST, LF856 (1st) | 2 1/2" & 3" | \$ 843.00 |
| 905479 | LF850 (1st & 2nd) 856ST, LF856 (1st) | 4" | 1,062.00 |
| 905480 | LF850 (1st & 2nd) 856ST, LF856 (1st) | 6" | 1,545.00 |
| 905481 | LF850 (1st & 2nd) 856ST, LF856 (1st) | 8" & 10" | 2,254.00 |
| 905482 | 856ST (2nd) | 2 1/2" & 3" | 923.00 |
| 905483 | 856ST (2nd) | 4" | 1,115.00 |
| 905484 | 856ST (2nd) | 6" | 1,619.00 |
| 905485 | 856ST (2nd) | 8" & 10" | 2,423.00 |
| 905612 | LF856 (2nd) | 2 1/2" & 3" | 899.50 |
| 905613 | LF856 (2nd) | 4" | 1,087.00 |
| 905614 | LF856 (2nd) | 6" | 1,578.00 |
| 905615 | LF856 (2nd) | 8" & 10" | 2,364.00 |

Kit Includes: Items 2, 3, 4, 5, 6, 10, 11, 12, 15, 22, 23, 24, 25, 26, 32, 33, 34, 35

Cover Assembly

| | | | |
|--------|-----|-------------|--------|
| 905376 | ALL | 2 1/2" & 3" | 328.50 |
| 905377 | ALL | 4" | 373.00 |
| 905378 | ALL | 6" | 431.00 |

Kit Includes: Items 7, 10, 18, 19